

PRODUCT SPECIFICATION SHEET

Product Title: 10m RJ45 CAT5e UTP Stranded Flush Moulded Network Cable - 24AWG - White

Product Code: 28-0100W | Brand: **connektgear**

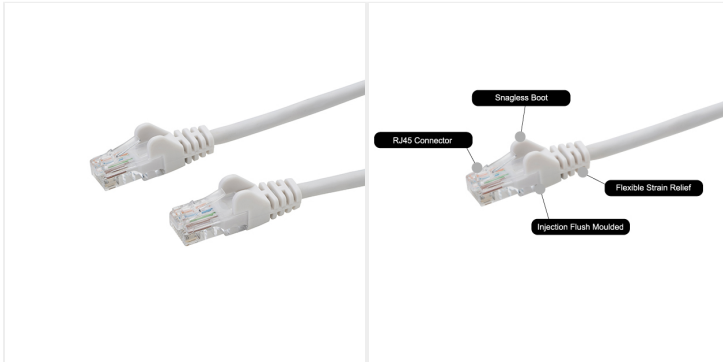

DESCRIPTION

Our CAT5e cables are perfect for connecting devices like computers, printers and smart TVs to a router, switch or modem. This allows them to join the local network (LAN) and access the internet seamlessly. CAT5e cables can support data transfer speeds of up to 100Mbps, making them ideal for everyday networking.

They are injection flush moulded meaning the boot is no larger than the RJ45 connector itself. This keeps the cable slim and easy to plug into devices like patch panels or side by side ports. The design also provides strain relief which reduces cable stress and lowers the risk of being damaged. In addition, the snagless boots protect the clip from breaking. Together, these features deliver enhanced durability, improved longevity and a professional appearance.

PRODUCT DETAILS

- Category 5 Enhanced certified & verified
- Speed: 100Mbps
- Frequency: 100mhz
- Unshielded Twisted Pair (UTP): 8 core/4 pairs of twisted wire
- Stranded: 7 strands within each core
- Snagless boots
- Injection flush moulded
- Flexible strain relief
- Lifetime warranty

TECHNICAL SPECIFICATIONS

- Connector 1: RJ45 Male
- Connector 2: RJ45 Male
- Gold plated contacts
- AWG: 24
- Cable length: 10m
- Colour: White

PACKAGING SPECIFICATIONS

Box Quantity: 25

Pack Type: Bag

Dimensions: 252(W) x 345(H) x 0.2(D)mm

Material: Bio Materials

Weight: 0.24

Gross Weight: 6.4875kg

Country: PR China

Barcode: 5035624020009
