

## PRODUCT SPECIFICATION SHEET

Product Title: 10m RJ45 CAT6 UTP Stranded Flush Moulded LS0H Network Cable - 24AWG - White

Product Code: 31-0100W | Brand: **connektgear**

---

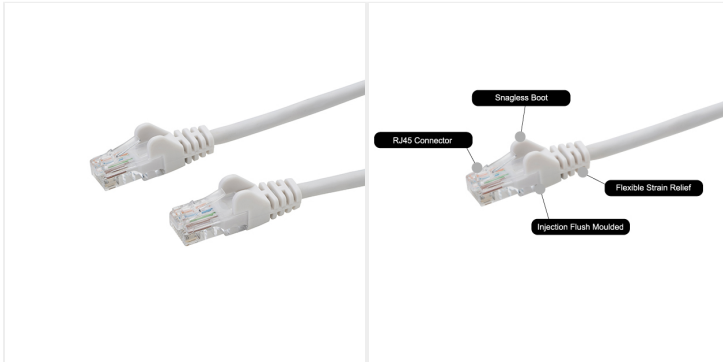

### DESCRIPTION

Our CAT6 cables are perfect for connecting devices like computers, printers and smart TVs to a router, switch or modem. This allows them to join the local network (LAN) and access the internet seamlessly. CAT6 cables can support data transfer speeds of up to 1Gbps, making them ideal for everyday networking.

They are injection flush moulded meaning the boot is no larger than the RJ45 connector itself. This keeps the cable slim and easy to plug into devices like patch panels or side by side ports. The design also provides strain relief which reduces cable stress and lowers the risk of being damaged. In addition, the snagless boots protect the clip from breaking. Together, these features deliver enhanced durability, improved longevity and a professional appearance.

### PRODUCT DETAILS

- Category 6 certified & verified
- Speed: 1Gbps
- Frequency: 250mhz
- Unshielded Twisted Pair (UTP): 8 core/4 pairs of twisted wire
- Stranded: 7 strands within each core
- Snagless boots
- Injection flush moulded
- Flexible strain relief
- Low smoke zero halogen (LSZH)
- Lifetime warranty

### TECHNICAL SPECIFICATIONS

- Connector 1: RJ45 Male
- Connector 2: RJ45 Male
- Gold plated contacts
- AWG: 24
- Cable length: 10m
- Colour: White

### PACKAGING SPECIFICATIONS

Box Quantity: 24

Pack Type: Bag

Dimensions: 252(W) x 345(H) x 0.2(D)mm

Material: Bio Materials

Weight: 0.26

Gross Weight: 6.7240kg

Country: PR China

---

Barcode: 5035624019317

---